

## Instructions for floating installation of parquet

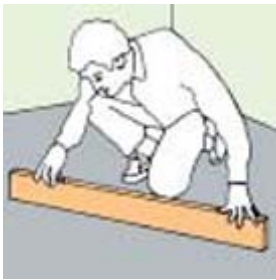

1. Check the evenness of the floor of the room. For this purpose use an approx. 2m long straight lath. If the floor deviation is more than 2mm, we suggest that you level the floor. In the case of a cement floor the moisture content of the floor should not be higher than 2 %.



2. Place a piece cut to the right length at the end of each row with the aid of a pull iron. The end also has to be fastened with a spacer. The firm, straight fastening of the first row with spacers is extremely important.



3. Never rely on the straightness of the wall. Check the straightness of the row using a thin strung thread. Start the second row with the parquet left over at the end of the first one.

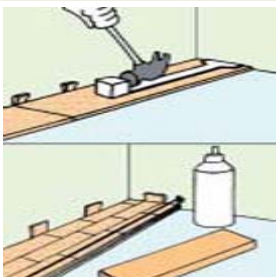

4. Put glue in the longitudinal groove over the whole length of the parquet. We recommend a dispersion glue used in the wood industry.

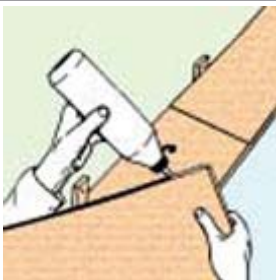

5. The glue must be used in a workman-like way; it should be placed onto the lower part of the groove. The glue must not be placed onto the tendons. If the glue is placed onto a wrong place, e.g. on the upper part of the groove or the tendon, it could cause a level difference between the parquet elements! The over dosage of the glue eliminates the perfect joint between the parquet elements.

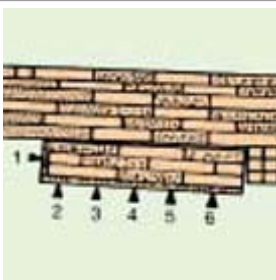

6. You can achieve a perfect fit by using the order of hammering shown in the picture.

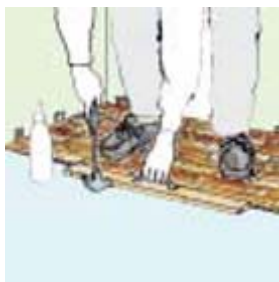

7.  
Fitting is done with a piece of wood used for hammering the parquet pieces together.

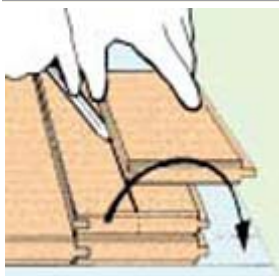

8.  
For the last row you might need to saw the parquet into two longitudinally. The line of sawing can be marked precisely as shown in the illustration.



9.  
Fit the last row of parquet in its place using the pull iron. The spacers have to be inserted by the wall here also. A 1-2 cm expansion joint also has to be left at thresholds and heating pipes. The installed parquet must not directly touch any wall or other structure of the building.



10.  
After the hardening of the glue (2-3 hours) the spacers have to be removed and the expansion joints have to be covered with skirting.

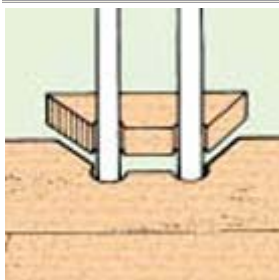

11.  
In case of passing pipes suitable compensation joints shall be maintained. The hole diameters shall be at least 20 mm bigger than the pipe diameter. Glue the cut-out piece back into its place and cover the opening with pipe collars. The door trim can be cut to the accurate length by laying down a piece of parquet waste and the parquet can be slipped under the door.

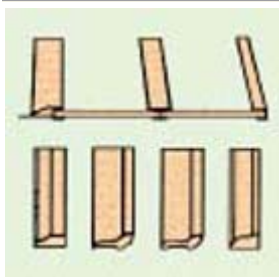

12.  
Various skirting and accessory elements.